

# TANASBOURNE MEDICAL AND DENTAL OFFICE

## Floor 1

- Conference Room A
- Conference Room B
- Occupational Therapy (101)
- Physical Therapy (101)
- Public Square
- Registration (Medical Appointments)
- Speech Therapy (101)

## Floor 1



## Floor 2

- Addiction Medicine (203)
- Conference Room C
- Dermatology (210)
- Mental Health (203)

## Floor 2

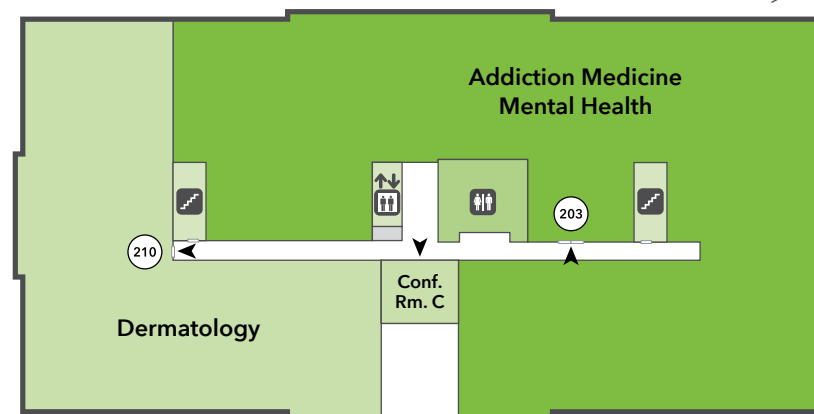

## Floor 3

- Dental (300)
- Registration (Dental Appointments)

## Floor 3

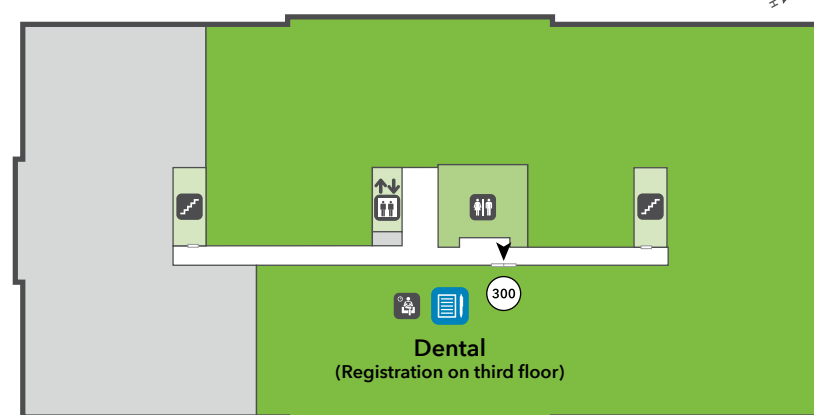

## Legend

- ★ Building Entrance
- Department Entrance
- 📄 Registration
- 👤 Waiting Area
- ♿ Restroom
- 🍴 Food and Drink
- 🏠 Stairs
- 🚗 Elevator

10315 NE Tanasbourne Drive, Hillsboro, OR 97124

Call us at 503-813-2000 or visit [kp.org](http://kp.org) for more information or to schedule an appointment.



# WELCOME

The future of health care: person-centered care for body, mind, and spirit, powered by innovation.



©2018 Kaiser Foundation Health Plan of the Northwest

219127861\_CARE\_03-18

All plans offered and underwritten by Kaiser Foundation Health Plan of the Northwest, 500 NE Multnomah St., Suite 100, Portland, OR 97232.

# Welcome to the new Kaiser Permanente Tanasbourne Medical and Dental Office

This is our vision for the future of health care delivery: person-centered care for body, mind, and spirit, powered by innovation.

We would like to introduce you to a few of the unique features you'll find here, each designed with you and your care in mind.

## BEFORE YOUR APPOINTMENT

### The Public Square

The Public Square is the heart of Tanasbourne Medical and Dental Office. We invite you to refuel at the café, use a tablet to explore health topics, or relax until we call you for your appointment.\*

Take a moment to pause and enjoy the work of local Northwest artists throughout our facility. These original pieces reflect the Chinook meaning of "Tanasbourne": land of many pretty creeks.

### The Appointment Status Board

Throughout the building, you will find screens displaying:

- The first three letters of your last name and first letter of your first name (for example, Jane Thomas is displayed as THO,J)
- Your appointment status and wait time\*
- Your appointment location

This appointment status board confirms your arrival and updates you on your expected wait time.

If you don't want your appointment listed on the board, just tell a registration representative at the front desk.

### Text Alerts

You may opt in to receive a text alert when your care team is ready to see you. Your decision to opt in or out of text alerts applies only to a given appointment. Each time you arrive here for an appointment, you may opt in or out of the text alert.

Note: This text alert is not the same as Kaiser Permanente's new appointment reminder text alert, which you can sign up for at [kp.org](http://kp.org).

## THE MEDICAL EXAM ROOM

We've reimagined our medical exam rooms to help you better connect with your care team.

- Rooms are larger and brighter than our standard exam rooms and are designed to encourage more conversation with your provider.
- Digital screens in exam rooms help your provider share notes and display other medical information.
- Tablets and software help your care team minimize the time you spend waiting in the exam room.

DEPARTMENTS AT TANASBOURNE:	
Addiction Medicine	Occupational Therapy
Dental (third floor)	Physical Therapy
Dermatology	Speech Therapy
Mental Health	

## GROUP THERAPY ROOMS

Our primary care, mental health, and addiction medicine providers work together to address your total health care needs. This facility has rooms dedicated to group treatment, where members can:

- Attend a wellness class
- Learn more about a mental health condition or how to support a loved one with a mental health condition
- Join a group therapy or recovery session

The space is designed to encourage greater connections among group members and to support members in their treatment.

## BEHIND THE SCENES: THE CARE TEAM EXPERIENCE

At Tanasbourne Medical and Dental Office, we want you to have the best care experience imaginable. That's why, in addition to rethinking the way you connect with your care team and experience our facility, we've transformed the environment in which your care team works. Staff and providers' spaces were designed to cultivate collaboration, improve coordination, foster productivity, and equip them with the resources they need to provide the best care to you.

Questions about Tanasbourne Medical and Dental Office? See a registration representative at the front desk.

Want to learn more about Kaiser Permanente's vision for the future or the new Beaverton Medical and Dental Office scheduled to open in spring 2019? Check out [kp.org/DesignedForLife](http://kp.org/DesignedForLife).

## GUIDE TO EXPRESS CHECK-IN:\*

- Check in for your appointment remotely via [kp.org](http://kp.org) or the Kaiser Permanente app on your mobile device.
- When you arrive, use a tablet or kiosk to let us know you're ready to be seen: Scan the code on your mobile device or enter your date of birth and health record number.
- Registration representatives are also available at the front desk to help.

\*Available starting in summer 2018.

## DON'T MISS:

- Tanasbourne Community Board: health-related information and community and facility activities
- Interactive maps for Tanasbourne and Westside Medical Center campus

\*Dental members: You must go to the third floor to check in and see your appointment status.